

SOUTH ROAD SUPERWAY TRAFFIC CHANGES

Grand Junction Road / South Road intersection closure

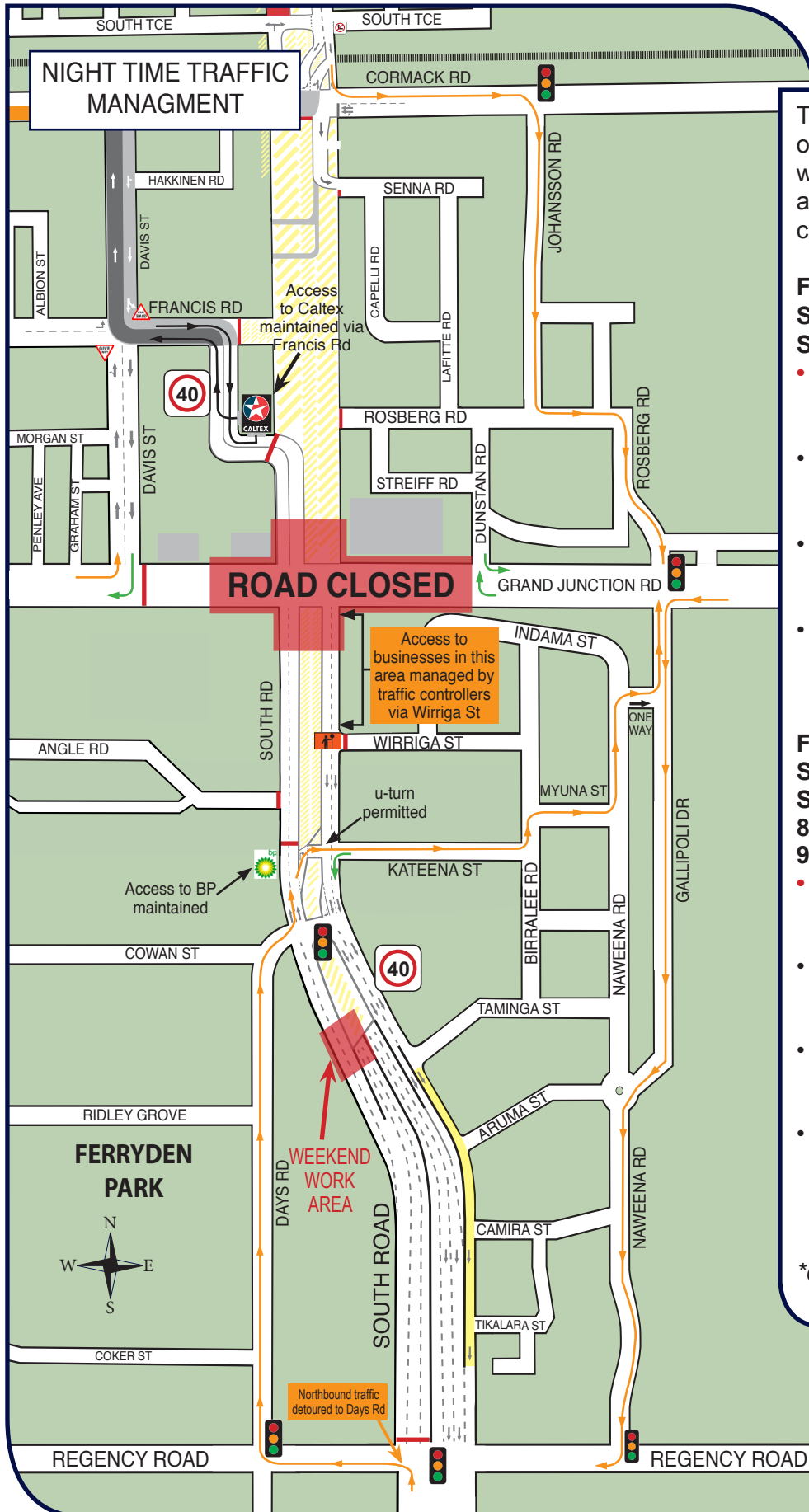

There will be changes to the flow of traffic in Regency Park this weekend to allow asphalt work and overhead grouting work to be carried out on the structure.

From 8.00pm Friday 6 September to 6.30am Saturday 7 September:

- **Grand Junction Rd / South Rd intersection will be fully closed.**
- Detours will be in place around the intersection during this time.
- Access to South Rd will be maintained from Days Rd and Kateena St.
- There will be no access to South Rd from Angle Rd and Werriga St.

From 6.30pm Saturday 7 September to 6.30am Sunday 8 September and 6.30pm Sunday 8 September to 6.30am Monday 9 September:

- **Grand Junction Rd / South Rd intersection will be fully closed.**
- Detours will be in place around the intersection during this time.
- Access to South Rd will be maintained from Days Rd and Kateena St.
- There will be no access to South Rd from Angle Rd and Werriga St.

**continued overleaf*

Construction area

* This map is indicative only and not to scale



Urban Superway, comprising John Holland Pty Ltd and Leed Engineering and Construction Pty Ltd, is the design and construction contractor delivering the \$842 million Australian and South Australian government funded South Road Superway with the Department of Planning, Transport and Infrastructure.

SOUTH ROAD SUPERWAY TRAFFIC CHANGES

Grand Junction Road / South Road intersection closure

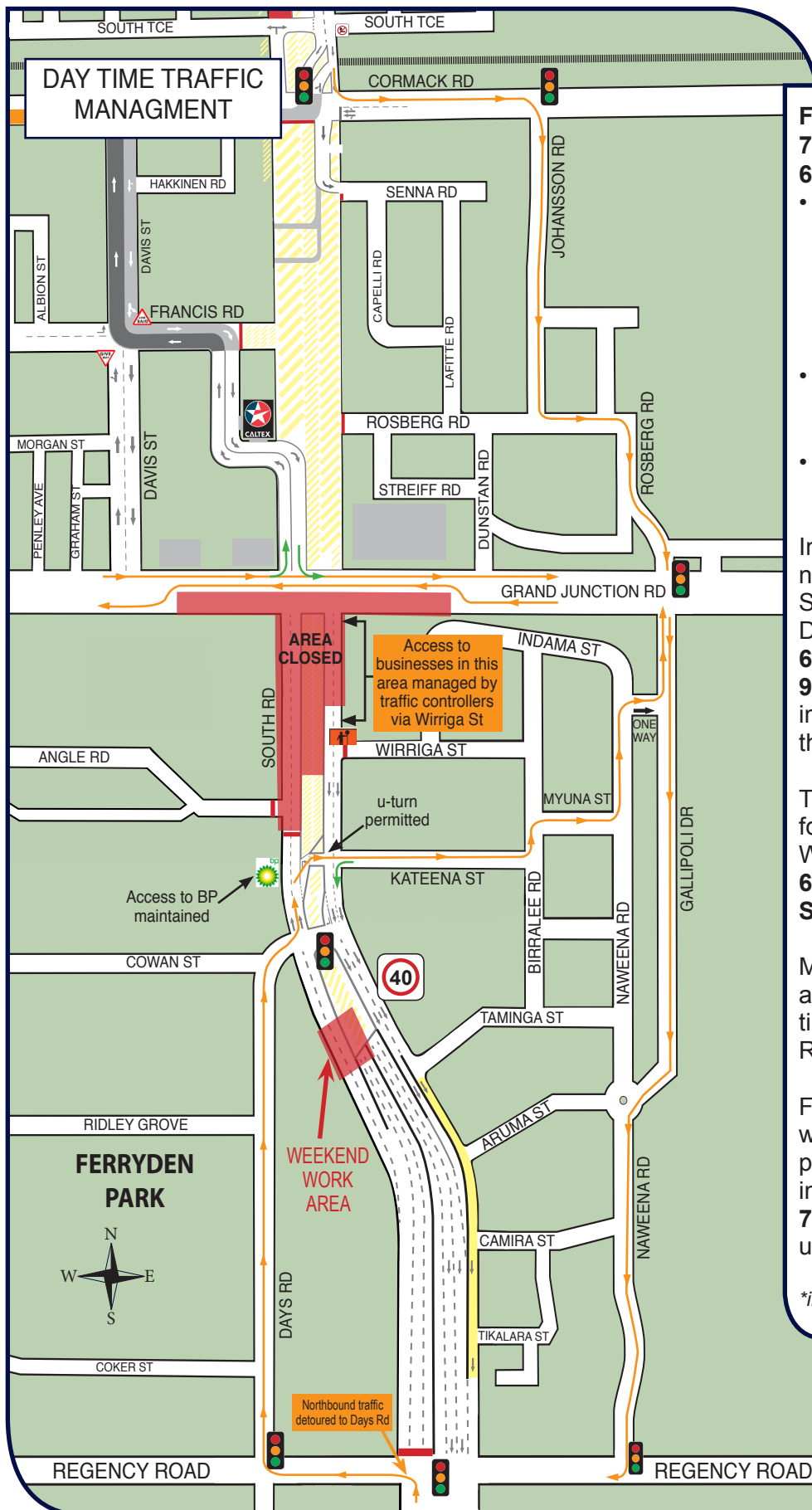

From 6.30am to 6.30pm Saturday 7 September and 6.30am to 6.30pm Sunday 8 September:

- Westbound traffic on Grand Junction Rd will contra flow to the eastbound lanes. One lane of traffic in each direction will be maintained on Grand Junction Rd.
- South Rd northbound traffic will detour to Gallipoli Dr via Kateena St.
- Angle Rd and Werriga St will be closed during this time.

In addition to the above, northbound traffic will detour from South Road to Regency Road and Days Road from **6.30pm Friday 6 September to 6.30am Monday 9 September** to allow for the installation of precast panels at the abutment on South Road.

There will be a southbound detour for traffic on South Road between Wing St and South Tce from **6.30am to 1.00pm Saturday 7 September**.

Motorists are encouraged to seek alternative routes during these times including Gallipoli Dr, Hanson Rd, Cormack Rd and Regency Rd.

For more information about this work or any other aspect of the project, please call the project information line on **1300 638 789** or email the contactus@urbansuperway.com.au

**inclement weather may alter these dates*

Construction area

* This map is indicative only and not to scale



Urban Superway, comprising John Holland Pty Ltd and Leed Engineering and Construction Pty Ltd, is the design and construction contractor delivering the \$842 million Australian and South Australian government funded South Road Superway with the Department of Planning, Transport and Infrastructure.